



INFRASTRUCTURE MODERNIZATION ACT OF 2018
EMERGENCY ROAD AND BRIDGE REPAIR FUND PROJECT

and

BOARD OF SUPERVISORS

JACKSON

County

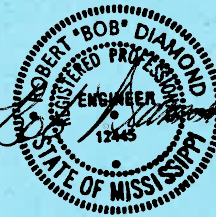

PROPOSAL AND CONTRACT DOCUMENTS

FOR THE CONSTRUCTION OF

ERBRF PROJECT NO. ERBR-30(02)

PARKERS LAKE BRIDGE

Being a Section of County Road in JACKSON

County, Mississippi

TYPE OF CONSTRUCTION Bridge Replacement with Approach Roadway

BRIDGE NUMBER(S) Bridge NO. SA30-036 Replaced With Bridge NO. SA30-A036

Net Length Miles 0.45 MI.

Gross Length Miles 0.45 MI. Contract Time 300 Working Days

By

Address

Surety

Note

Standard Specifications for State Aid Road and Bridge Construction currently approved by the Office of State Aid Road Construction and the Federal Highway Administration are made a part hereof fully and completely as if attached hereto, except where superseded by the Special Provisions, or amended by revisions.

JACKSON COUNTY BOARD OF SUPERVISORS
EMERGENCY ROAD AND BRIDGE REPAIR FUNDED PROJECT

SECTION 900

NOTICE TO CONTRACTORS:

Notice is hereby given that sealed or electronic bids will be received by the Board of Supervisors of Jackson County, Mississippi until 12:00 p.m. on the 24 day of November, **2020**, and said bids are to be opened at 1:00 p.m. after the receipt thereof and read aloud in the Board of Supervisors' Meeting Room located in the Jackson County Services Building, 2915 Canty Street, Pascagoula, MS 39567.

Envelopes containing the bid must be sealed, addressed to The Clerk of the Board of Jackson County, and designated as bids for the construction of Parkers Lake Bridge, ERBR-30 (02).

Contractors have the option of submitting their bids sealed in an envelope or electronically through www.jacksoncoplans.com. If a sealed envelope bid is submitted by mail, the post office address of the Chancery Clerk is P.O. Box 998, Pascagoula, MS 39568. Bids may be delivered to Josh Eldridge, Chancery Clerk, c/o Land Records Department, 2915 Canty Street, Suite R, Pascagoula, MS 39567.

All bid envelopes should contain the bidder's name and mailing address on the outside of the envelope and specify the name of the bid item. Proposals must be accompanied by a Proposal Guaranty consisting of a Bid Bond, Cashier's Check or Certified Check in the amount of 5% of the amount of the bid.

Bidder's certificate of responsibility number or a statement that the bid inside is less than \$50,000 shall appear on the outside or exterior of the envelope or container of such bids, failing which, said bid shall not be opened or considered.

Copies of the Contract Documents may be examined at the following locations:

- Batson & Brown, Inc; 4347 Old Spanish Trail; Gautier, MS 39553
- AGC Plan Room; 12272 Intraplex Parkway; Gulfport, MS 39503
- ABC Plan Room; 10480 Corporate Drive, Suite 2; Gulfport, MS 39503
- Or online at www.jacksoncoplans.com.

This project allows for a Contract Time of 300 Calendar Days and shall be constructed in accordance with the latest edition of the Mississippi Standard Specifications for State Aid Road and Bridge Construction.

PLANS AND PROPOSALS may be secured online from the reference website or obtained from the offices of Batson & Brown, Inc., 4347 Old Spanish Trail, Gautier, MS 39553, or either 11267 Old 63 South, Lucedale, MS, 39452, upon payment of \$250.00 (non-refundable) for each set.

For an electronic bid, documents can be downloaded from Plan House Plan Room. Electronic bids shall be submitted at www.jacksoncoplans.com. For any questions relating to the electronic bidding process, please call Plan House Plan Room at 662-407-0193.

The Board of Supervisors hereby notifies all bidders that it will affirmatively insure that in any contract entered into pursuant to this advertisement; minority business enterprise will be afforded full opportunity to submit bids in response to this invitation and will not be discriminated against on the grounds of race, color, or national origin in consideration for an award.

The County reserves the right to reject all bids, to waive any informalities and to postpone the award of the Contract for a period of time which, however, shall not extend beyond 60 days from the bid opening date.

Barry Cumbest, President
Jackson County Board of Supervisors

Publication dates:
October 25, 2020
November 1, 2020

For the construction of: BRIDGE REPLACEMENT AND APPROACH ROADWAY on 0.45 mile(s) of county road known as Wade-Vancleave Road in JACKSON County, Mississippi under JACKSON COUNTY ERBR-30(02)

I (We) agree to complete the entire project within 300 calendar days.

SPECIAL NOTICE TO BIDDERS

BIDS WILL NOT BE CONSIDERED UNLESS BOTH UNIT PRICES AND ITEM TOTALS ARE ENTERED

| Ref. No. | Pay Item No. | Work Description | Approx. Quantity | Unit | Unit Price | Item Total |
|----------------------|--------------|--|------------------|------|------------|------------|
| Roadway Items | | | | | | |
| 1 | S-200-A | MOBILIZATION | 1 | LS | | |
| 2 | S-201-A | CLEARING AND GRUBBING | 1 | LS | | |
| 3 | S-202-B | REMOVAL OF EXISTING BRIDGE (STA. 20+88.53) | 1 | UNIT | | |
| 4 | S-202-D | REMOVAL OF ASPHALT PAVING (ALL DEPTHS) | 4761 | SQ | | |
| 5 | S-203-A | UNCLASSIFIED EXCAVATION (FM) | 1238 | CY | | |
| 6 | S-203-E | BORROW EXCAVATION (CONTRACTOR FURNISHED) (LVM) (CLASS 7) | 59590 | CY | | |
| 7 | S-240-A | GEOGRID TYPE III (TRIAxIAL TYPE - TX160 OR EQUIV) | 5858 | SQ | | |
| 8 | S-304-C | CRUSHED STONE (SIZE 610) (LVM) | 3501 | CY | | |
| 9 | S-403-A | HOT MIX ASPHALT, ST, 9.5 MM | 517 | TON | | |
| 10 | S-403-A | HOT MIX ASPHALT, ST, 12.5 MM | 1123 | TON | | |
| 11 | S-406-A | COLD MILLING OF BITUMINOUS PAVEMENT, ALL DEPTHS | 367 | SY | | |
| 12 | S-606-B | GUARDRAIL, "W" BEAM | 275 | LF | | |
| 13 | S-606-D | GUARDRAIL, BRIDGE END SECTION, TYPE "I" THRIE BEAM | 4 | EA | | |
| 14 | S-606-E | GUARDRAIL, TERMINAL END SECTION | 4 | EA | | |
| 15 | S-617-A | RIGHT-OF-WAY MARKERS (TYPE "I") | 10 | EA | | |
| 16 | S-618-A | MAINTENANCE OF TRAFFIC | 1 | LS | | |
| 17 | S-618-B | ADDITIONAL CONSTRUCTION SIGNS | 0 | SF | 10.00 | 0.00 |
| 18 | S-619-E | 4" WIDE TEMPORARY TRAFFIC STRIPE (CONTINUOUS YELLOW) | 3698 | LF | | |
| 19 | S-619-E | 4" WIDE TEMPORARY TRAFFIC STRIPE (CONTINUOUS WHITE) | 3524 | LF | | |
| 20 | S-619-E | 4" WIDE TEMPORARY TRAFFIC STRIPE (WHITE DETAIL) | 126 | LF | | |
| 21 | S-620-C | 4" WIDE COLD PLASTIC EDGE STRIPE (CONTINUOUS WHITE) | 0.21 | MI | | |
| 22 | S-620-E-1 | 4" WIDE COLD PLASTIC EDGE STRIPE (CONTINUOUS YELLOW) | 1104 | LF | | |

SECTION 902 PROPOSAL
PAGE 2

SPECIAL NOTICE TO BIDDERS

BIDS WILL NOT BE CONSIDERED UNLESS BOTH UNIT PRICES AND ITEM TOTALS ARE ENTERED

| Ref. No. | Pay Item No. | Work Description | Approx. Quantity | Unit | Unit Price | Item Total |
|---|--------------|--|------------------|------|------------|------------|
| ROADWAY ITEMS CONTINUED | | | | | | |
| 23 | S-621-C | 4" WIDE THERMOPLASTIC EDGE STRIPE (CONTINUOUS WHITE)(60 MILS) | 0.67 | MI | | |
| 24 | S-621-E-1 | 4" WIDE THERMOPLASTIC TRAFFIC STRIPE (CONTINUOUS YELLOW) (90 MILS) | 3698 | LF | | |
| 25 | S-621-H-1 | THERMOPLASTIC LEGEND (WHITE)(120 MILS) | 126 | LF | | |
| 26 | S-627-J | TWO-WAY CLEAR REFLECTIVE HIGH PERFORMANCE RAISED MARKER | 60 | EA | | |
| 27 | S-627-L | TWO-WAY YELLOW REFLECTIVE HIGH PERFORMANCE RAISED MARKER | 10 | EA | | |
| 28 | S-630-B | REFLECTORIZED TRAFFIC REGULATORY SIGN (ENCAPSULATED LENS) | 2 | EA | | |
| 29 | S-630-C | REFLECTORIZED TRAFFIC OBJECT MARKER(ENCAPSULATED LENS) TYPE 3 | 4 | EA | | |
| 30 | S-631-A | FLOWABLE FILL | 240 | CY | | |
| 31 | S-815-E | GEOTEXTILE UNDER BRIDGE END TREATMENT, TYPE V, A.C.S. 0.21 - 0.43 | 372 | SY | | |
| Subtotal Roadway Items = | | | | | | |
| EROSION CONTROL ITEMS | | | | | | |
| 32 | S-211-B | TOPSOIL FOR SLOPE TREATMENT (CONTRACT FURNISHED) (LVM) | 2652 | CY | | |
| 33 | 901-S-212-A | AGRICULTURAL LIMESTONE | 6.2 | TON | | |
| 34 | S-212-B | COMMERCIAL FERTILIZER (13-13-13) | 3.1 | TON | | |
| 35 | S-212-F | AMMONIUM NITRATE | 0.80 | TON | | |
| 36 | S-214-A | SEEDING | 3.1 | ACRE | | |
| 37 | S-215-A | VEGETATIVE MATERIALS FOR MULCH | 6.2 | TON | | |
| 38 | S-226-A | SOLID SODDING | 2500 | SY | | |
| 39 | S-227-A | EXCELSIOR BLANKET | 15910 | SY | | |
| 40 | S-233-A | TEMPORARY SILT FENCE (TYPE I)(AOS 0.15-0.84) | 2878 | LF | | |
| 41 | 907-237-A | WATTLE 20" | 740 | LF | | |
| Subtotal Erosion Control Items = | | | | | | |

SPECIAL NOTICE TO BIDDERS

BIDS WILL NOT BE CONSIDERED UNLESS BOTH UNIT PRICES AND ITEM TOTALS ARE ENTERED

| Ref. No. | Pay Item No. | Work Description BRIDGE ITEMS | Approx. Quantity | Unit | Unit Price | Item Total |
|-------------------------|--------------|--|------------------|------|------------|------------|
| 42 | 901-S-803-I | PDA TEST PILE | 4 | EA | | |
| 43 | S-803-B | CONVENTIONAL STATIC PILE LOAD TEST | 2 | EA | | |
| 44 | S-803-C | 14" PRESTRESSED CONCRETE PILING | 1275 | LF | | |
| 45 | S-803-C | 18" PRESTRESSED CONCRETE PILING | 1885 | LF | | |
| 46 | S-803-F | 18" PRE-FORMED PILE HOLE | 540 | LF | | |
| 47 | S-803-F | 24" PRE-FORMED PILE HOLE | 420 | LF | | |
| 48 | 901-S-803-J | PILE RESTRIKE | 4 | EA | | |
| 49 | S-803-K | DRILLED SHAFT, 72" DIAMETER | 816 | LF | | |
| 50 | S--803-M | TRIAL SHAFT 72" DIAMETER | 134 | EA | | |
| 51 | S-803-N | EXPLORATION | 120 | LF | | |
| 52 | S-803-O | TEMPORARY CASING, 72" DIAMETER | 450 | LF | | |
| 53 | S-804-A | BRIDGE CONCRETE, CLASS AA | 850.7 | CY | | |
| 54 | S-804-C | 110' PRESTRESSED CONCRETE BEAM, TYPE 1+2 | 3842 | LF | | |
| 55 | S-805-A | REINFORCEMENT | 150724 | LBS | | |
| 56 | S-813-A | CONCRETE RAILING | 1100.00 | LF | | |
| 57 | S-815-A | LOOSE RIPRAP, 300 LB. | 1414.0 | TON | | |
| 58 | S-815-E | GEOTEXTILE UNDER RIPRAP, TYPE V A.O.S. 0.21-0.43 | 2619 | SQ | | |
| Subtotal Bridge Items = | | | | | | |
| Total Bid = | | | | | | |

STATE OF MISSISSIPPI
JACKSON COUNTY BOARD OF SUPERVISORS
INFRASTRUCTURE MODERNIZATION ACT OF 2013
EMERGENCY ROAD AND BRIDGE REPAIR FUNDED PROJECT
PARKERS LAKE BRIDGE, WADE VANCLEAVE ROAD
ERBRF PROJECT NO. ERBR-30(02)
JACKSON COUNTY

LENGTH DATA

EXCEPTIONS

NONE

EQUATIONS

NONE

| | | |
|---------------------------|--------------|----------|
| LENGTH OF ROADWAY | 1,848.94 FT. | 0.35 MI. |
| LENGTH OF BRIDGES | 552.25 FT. | 0.10 MI. |
| LENGTH OF PROJECT (NET) | | 0 MI. |
| LENGTH OF EXCEPTIONS | | 0.45 MI. |
| LENGTH OF PROJECT (GROSS) | 2,401.19 FT. | 0.45 MI. |

PLAN 1" = 50'
PROFILE HORIZ: 1" = 50'
VERT: 1" = 5'
TITLE 1" = 2640'

BRIDGE REPLACES BRIDGE NO.
SA-30-036
WITH SA-30-A036

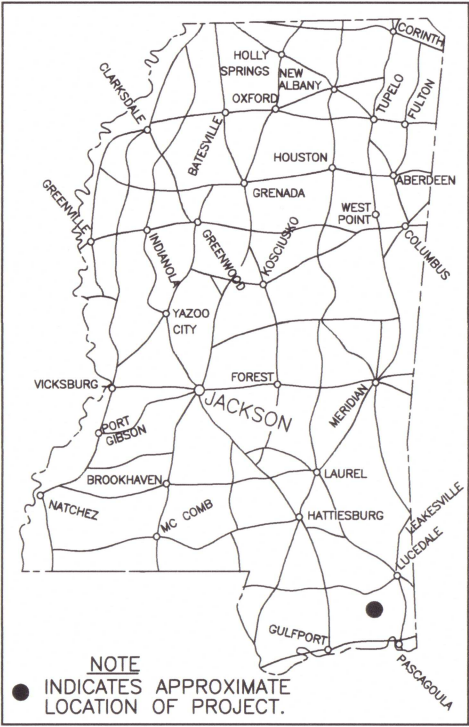
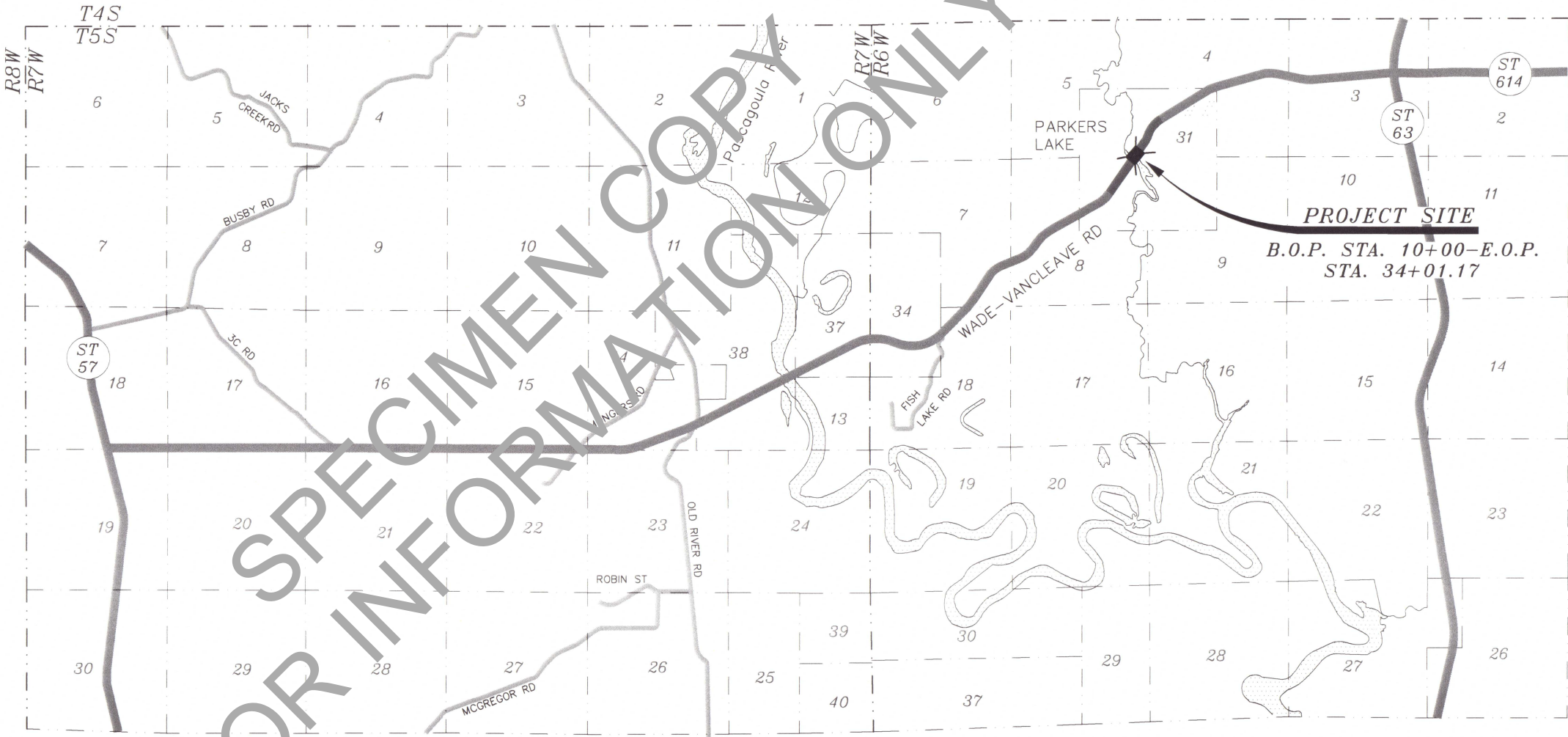

INDEX

FOR INDEX SEE SHEET NO. 2

BOARD OF SUPERVISORS

- BARRY CUMBEST - DISTRICT 1
- MELTON HARRIS - DISTRICT 2
- KEN TAYLOR - DISTRICT 3
- TROY ROSS - DISTRICT 4
- RANDY BOSARGE - DISTRICT 5

COUNTY ROAD MANAGER

- JOE O'NEAL - ROAD MANAGER
- WENDY BROUSSARD - COUNTY ENGINEER



PLANS DESIGNED BY:

Batson and Brown
Engineers and Surveyors

NEEL-SCHAFER
Solutions you can build upon

PREPARED BY

Bob Diamond

PROJECT ENGINEER

10/26/2020

DATE

STANDARD SPECIFICATIONS FOR STATE AID ROAD AND BRIDGE
CONSTRUCTION CURRENTLY APPROVED BY THE OFFICE OF STATE AID ROAD
CONSTRUCTION OF THE MISSISSIPPI DEPARTMENT OF TRANSPORTATION AND
THE FEDERAL HIGHWAY ADMINISTRATION ARE MADE A PART HEREOF FULLY
AND COMPLETELY AS IF ATTACHED HERETO, EXCEPT WHERE SUPERSEDED
BY THE SPECIAL PROVISIONS, OR AMENDED BY REVISIONS.

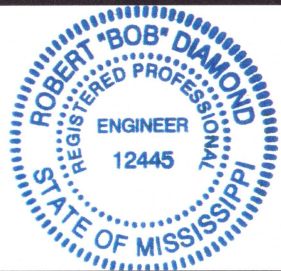

PREPARED BY
Bob Diamond
PROJECT ENGINEER
10/26/2020
DATE

SUMMARY OF QUANTITIES (CONT.)

| PAY ITEM NO. | PAY ITEM | QUANTITY | | UNITS |
|--------------|---|----------|-------|---------|
| | | PLAN | FINAL | |
| BRIDGE ITEMS | | | | |
| 901-S-803-I | PDA TEST PILE | 4 | | EACH |
| S-803-B | CONVENTIONAL STATIC PILE LOAD TEST | 2 | | EACH |
| S-803-C | 14" PRESTRESSED CONCRETE PILING | 1275 | | L.F. |
| S-803-C | 18" PRESTRESSED CONCRETE PILING | 1885 | | L.F. |
| S-803-F | 18" PRE-FORMED PILE HOLE | 540 | | L.F. |
| S-803-F | 24" PRE-FORMED PILE HOLE | 420 | | L.F. |
| 901-S-803-J | PILE RESTRIKE | 4 | | EACH |
| S-803-K | DRILLED SHAFT, 72" DIAMETER | 816 | | L.F. |
| S-803-M | TRIAL SHAFT, 72" DIAMETER | 134 | | L.F. |
| S-803-N | EXPLORATION | 120 | | L.F. |
| S-803-O | TEMPORARY CASING, 72" DIAMETER | 450 | | L.F. |
| S-804-A | BRIDGE CONCRETE, CLASS AA | 850.7 | | CU. YD. |
| S-804-C | 110' PRESTRESSED CONCRETE BEAM, TYPE 1+2 | 3842 | | L.F. |
| S-805-A | REINFORCEMENT | 150724 | | LBS |
| S-813-A | CONCRETE RAILING | 1100 | | L.F. |
| S-815-A | LOOSE RIPRAP, 300 LB | 1414 | | TON |
| S-815-E | GEOTEXTILE UNDER RIPRAP, TYPE V, A.O.S. 0.21-0.43 | 2619 | | SQ. YD. |
| | | | | |

- ① 1,000 SQ. YD'S. GEOGRID TO BE USED AS DIRECTED BY THE ENGINEER.
- ② QUANTITIES BASED ON 6" THICKNESS. THICKNESS APPLIED TO ROADWAY SHALL BE DETERMINED BY THE ENGINEER BEFORE PLACEMENT. (INCLUDES 165 CU. YD. TO BE USED AS DIRECTED BY ENGINEER.)
- ③ VANDAL RESISTANT HARDWARE REQUIRED.
- ④ TO BE USED UNDER BRIDGE ABUTMENTS.
- ⑤ 500 SQ. YD'S. SOLID SOD TO BE USED AS DIRECTED BY THE ENGINEER.
- ⑥ PER MISSISSIPPI STANDARD SPECIFICATIONS FOR ROAD AND BRIDGE CONSTRUCTION, MDOT, 2017 EDITION.
- ⚡ CEMENTITIOUS EXPOSURE TO SULFATES IS NEGLIGIBLE.

NOTE:
INCIDENTAL WORK FOR WHICH NO PAY ITEM IS PROVIDED IN THE PROPOSAL SHALL BE CONSIDERED INCLUDED IN THE PRICES AND PAYMENT FOR BID ITEMS.

| | | |
|-----------------------|-------------------|--|
| REVISED 10/21/2020 | DATE: 02/19/19 | QUANTITY SHEET |
| COMPLETED | DR. BY MASON | |
| | CHECKED BOB | |
| | SCALE N.T.S. | |
| | | BATSON AND BROWN, INC. GAUTIER □ LUCEDALE □ PASCAGOULA, MISSISSIPPI CONSULTING ENGINEERS |

SUMMARY OF QUANTITIES

| PAY ITEM NO. | PAY ITEM | QUANTITY | | UNITS |
|-----------------------|--|----------|-------|----------|
| | | PLAN | FINAL | |
| ROADWAY ITEMS | | | | |
| S-200-A | MOBILIZATION | LUMP SUM | | LUMP SUM |
| S-201-A | CLEARING AND GRUBBING | LUMP SUM | | LUMP SUM |
| S-202-A | REMOVAL OF BRIDGE | 1 | | UNIT |
| S-202-D | REMOVAL OF ASPHALT PAVING (ALL DEPTHS) | 4761 | | SQ. YD. |
| S-203-A | UNCLASSIFIED (FM) | 1238 | | CU. YD. |
| S-203-E | BORROW EXCAVATION (CONTRACTOR FURNISHED LVM, CLASS 7) | 59590 | | CU. YD. |
| S-240-A | GEOGRID, TYPE III | 5858 | | SQ. YD. |
| S-304-C | CRUSHED STONE (LVM)(SIZE 610) | 3501 | | CU. YD. |
| S-403-A | HOT MIX ASPHALT, (ST)(9.5mm) | 517 | | TON |
| S-403-A | HOT MIX ASPHALT, (ST)(12.5mm) | 1123 | | TON |
| S-406-A | COLD MILLING OF BITUMINOUS PAVEMENT, ALL DEPTHS | 367 | | SQ. YD. |
| S-606-B | GUARDRAIL "W" BEAM | 275 | | L.F. |
| S-606-D | GUARDRAIL, BRIDGE END SECTION, TYPE "I" THRIE BEAM | 4 | | EACH |
| S-606-E | GUARDRAIL, TERMINAL END SECTION | 4 | | EACH |
| S-617-A | RIGHT-OF-WAY MARKERS (TYPE I) | 10 | | EACH |
| S-618-A | MAINTENANCE OF TRAFFIC | LUMP SUM | | LUMP SUM |
| S-618-B | ADDITIONAL CONSTRUCTION SIGNS | 0.0 | | SQ. FT. |
| S-619-E | 4" WIDE TEMPORARY TRAFFIC STRIPE (CONTINUOUS YELLOW) | 3698 | | L.F. |
| S-619-E | 4" WIDE TEMPORARY TRAFFIC STRIPE (CONTINUOUS WHITE) | 3524 | | L.F. |
| S-619-E | 4" WIDE TEMPORARY TRAFFIC STRIPE (WHITE DETAIL) | 126 | | L.F. |
| S-620-C | 4" WIDE COLD PLASTIC EDGE STRIPE (CONTINUOUS WHITE) | 0.21 | | MI. |
| S-620-E-1 | 4" WIDE COLD PLASTIC EDGE STRIPE (CONTINUOUS YELLOW) | 1104 | | L.F. |
| S-621-C | 4" WIDE THERMOPLASTIC EDGE STRIPE (CONTINUOUS WHITE)(60 MILS) | 0.67 | | MI. |
| S-621-E-1 | 4" WIDE THERMOPLASTIC TRAFFIC STRIPE (CONTINUOUS YELLOW)(90 MILS) | 3698 | | L.F. |
| S-621-H-1 | THERMOPLASTIC LEGEND (WHITE)(120 MILS) | 126 | | L.F. |
| S-627-J | TWO-WAY CLEAR REFLECTIVE HIGH PERFORMANCE RAISED MARKERS | 60 | | EACH |
| S-627-L | TWO-WAY YELLOW REFLECTIVE HIGH PERFORMANCE RAISED MARKERS | 10 | | EACH |
| S-630-B | REFLECTORIZED TRAFFIC REGULATORY SIGN (ENCAPSULATED LENS) | 2 | | EACH |
| S-630-C | REFLECTORIZED TRAFFIC OBJECT MARKER SIGN (ENCAPSULATED LENS)(TYPE 3) | 4 | | EACH |
| S-631-A | FLOWABLE FILL | 240 | | CU. YD. |
| S-815-E | GEOTEXTILE UNDER BRIDGE END TREATMENT, TYPE V, A.O.S. 0.21-0.43 | 372 | | SQ. YD. |
| EROSION CONTROL ITEMS | | | | |
| S-211-B | TOPSOIL FOR SLOPE TREATMENT (CONTR FURNISHED)(LVM) | 265 | | CU. YD. |
| 901-S-212-A | AGRICULTURAL LIMESTONE | 6.2 | | TON |
| S-212-B | COMMERCIAL FERTILIZER (13-13-13) | 1 | | TON |
| S-212-F | AMMONIUM NITRATE | 0.8 | | TON |
| S-214-A | SEEDING | 3.1 | | ACRE |
| S-215-A | VEGETATIVE MATERIALS FOR MULCH | 6.2 | | TON |
| S-226-A | SOLID SODDING | 250 | | SQ. YD. |
| S-227-A | EXCELSIOR BLANKET | 1910 | | SQ. YD. |
| S-233-A | TEMPORARY SILT FENCE (TYPICAL)(AOS 0.15-0.84) | 28.3 | | L.F. |
| 237-A | WATTLES, 20" | 740 | | L.F. |



1
2
3
4
5
6
7
8
9
10
11
12
13
14
15
16
17
18
19
20
21
22
23
24
25
26
27
28
29
30
31
32
33
34
35
36
37
38
39
40
41
42
43
44
45
46
47
48
49
50
51
52
53
54
55
56
57
58
59
60
61
62
63
64
65
66
67
68
69
70
71
72
73
74
75
76
77
78
79
80
81
82
83
84
85
86
87
88
89
90
91
92
93
94
95
96
97
98
99
100
101
102
103
104
105
106
107
108
109
110
111
112
113
114
115
116
117
118
119
120
121
122
123
124
125
126
127
128
129
130
131
132
133
134
135
136
137
138
139
140
141
142
143
144
145
146
147
148
149
150
151
152
153
154
155
156
157
158
159
160
161
162
163
164
165
166
167
168
169
170
171
172
173
174
175
176
177
178
179
180
181
182
183
184
185
186
187
188
189
190
191
192
193
194
195
196
197
198
199
200
201
202
203
204
205
206
207
208
209
210
211
212
213
214
215
216
217
218
219
220
221
222
223
224
225
226
227
228
229
230
231
232
233
234
235
236
237
238
239
240
241
242
243
244
245
246
247
248
249
250
251
252
253
254
255
256
257
258
259
260
261
262
263
264
265
266
267
268
269
270
271
272
273
274
275
276
277
278
279
280
281
282
283
284
285
286
287
288
289
290
291
292
293
294
295
296
297
298
299
300
301
302
303
304
305
306
307
308
309
310
311
312
313
314
315
316
317
318
319
320
321
322
323
324
325
326
327
328
329
330
331
332
333
334
335
336
337
338
339
340
341
342
343
344
345
346
347
348
349
350
351
352
353
354
355
356
357
358
359
360
361
362
363
364
365
366
367
368
369
370
371
372
373
374
375
376
377
378
379
380
381
382
383
384
385
386
387
388
389
390
391
392
393
394
395
396
397
398
399
400
401
402
403
404
405
406
407
408
409
410
411
412
413
414
415
416
417
418
419
420
421
422
423
424
425
426
427
428
429
430
431
432
433
434
435
436
437
438
439
440
441
442
443
444
445
446
447
448
449
450
451
452
453
454
455
456
457
458
459
460
461
462
463
464
465
466
467
468
469
470
471
472
473
474
475
476
477
478
479
480
481
482
483
484
485
486
487
488
489
490
491
492
493
494
495
496
497
498
499
500
501
502
503
504
505
506
507
508
509
510
511
512
513
514
515
516
517
518
519
520
521
522
523
524
525
526
527
528
529
530
531
532
533
534
535
536
537
538
539
540
541
542
543
544
545
546
547
548
549
550
551
552
553
554
555
556
557
558
559
560
561
562
563
564
565
566
567
568
569
570
571
572
573
574
575
576
577
578
579
580
581
582
583
584
585
586
587
588
589
590
591
592
593
594
595
596
597
598
599
600
601
602
603
604
605
606
607
608
609
610
611
612
613
614
615
616
617
618
619
620
621
622
623
624
625
626
627
628
629
630
631
632
633
634
635
636
637
638
639
640
641
642
643
644
645
646
647
648
649
650
651
652
653
654
655
656
657
658
659
660
661
662
663
664
665
666
667
668
669
670
671
672
673
674
675
676
677
678
679
680
681
682
683
684
685
686
687
688
689
690
691
692
693
694
695
696
697
698
699
700
701
702
703
704
705
706
707
708
709
710
711
712
713
714
715
716
717
718
719
720
721
722
723
724
725
726
727
728
729
730
731
732
733
734
735
736
737
738
739
740
741
742
743
744
745
746
747
748
749
750
751
752
753
754
755
756
757
758
759
760
761
762
763
764
765
766
767
768
769
770
771
772
773
774
775
776
777
778
779
780
781
782
783
784
785
786
787
788
789
790
791
792
793
794
795
796
797
798
799
800
801
802
803
804
805
806
807
808
809
810
811
812
813
814
815
816
817
818
819
820
821
822
823
824
825
826
827
828
829
830
831
832
833
834
835
836
837
838
839
840
84